



Hose Retrofit for Liquid Cooled Converters

Proven and reliable solution for your liquid cooled converters

MODERNIZATION TO 24° CONE DKO FITTINGS & SELF-GRIP HOSE SEALING SYSTEM

At GE, we support our customers with modernization and retrofit programs. GE has developed various retrofit programs using the latest technologies available today, offering solutions to fulfill the customer's expectations such as reliability, performance, availability and a trouble-free drive operations. You can rely upon GE to bring latest technology through our retrofit programs.

GE offers a bespoke hose retrofit solution specific to your liquid cooled converters. The 24° cone connectors with O-ring cone sealing system (referred to as DKO-end according to ISO 8434-1) is the latest industrial standard of choices for all our AC and DC drives that is proven already in our MV range drive applications

KEY BENEFITS

- Reliable, durable, versatile and ideal for clean production environment.
- High functional safety with quick and easy assembly and disassembly.
- Preventive exchange save high repair costs in case of tube aging.
- Offers the possibility to exchange power stacks easily by unscrewing tubing nut instead of removing the entire tubing.

IMPROVED SEALING COMPATIBILITY

Based on this solution GE recommends the replacement of legacy hose systems installed in your liquid cooled converters with the 24° cone connectors comprising of O-ring seal cone and the self-grip nitrile hose system.

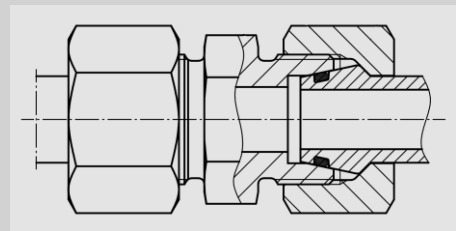

The sealing system consists of a metallic seal cone with elastomer O-ring that provides excellent sealing action and long life. This connection is resistant to pressure impacts and vibrations even under high loads.

During fitting, a high initial compression force is applied on the O-ring seal, and it does not require tightening even after years of operation under extreme working conditions. However, to maintain a safe working environment, GE also recommends the exchange of hoses every 6 years, ensuring compliance to Environment, Health and Safety (EHS) and all major regulations.

INSTALLATION & TESTING SUPPORT

GE provides field service support as additional offering for the installation, testing and certification processes.



Existing hose
(Silicone tube)



Flat sealed manifold



Self-grip hose
Nitrile (NBR)

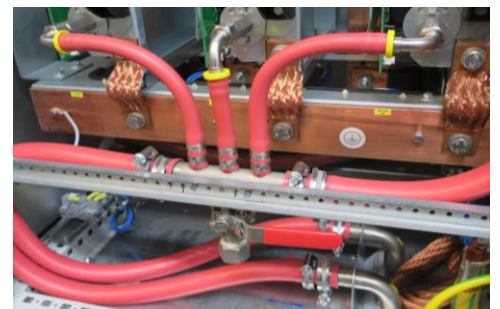

24° cone connector with O-ring seal cone
(DKO-end) sealing assembly

Contact us: services.powerconversion@ge.com